

## INSTALLATION INSTRUCTIONS

### VEHICLE APPLICATION

Year: **2015 - 2016**  
Make: **Yamaha**  
Model: **YXZ1000R, SE**  
Engine: **998cc**

### TOOLS REQUIRED

- 2.5mm, 4mm, 5mm Hex Key
- 10mm, 12mm, 13mm Wrench/Socket
- 5/16 Nut Driver
- Wire Stripper
- Phillips Screwdriver, Flat Blade Screwdriver, Razor Blade, and Wire Cutters

### BEFORE YOU START

- Please read the entire installation manual before proceeding.
- Ensure all components listed on page 9 are present.
- If you are missing any of the components, call our customer support at (909) 947-0015.
- Do not work on the vehicle while the engine is hot.
- Make sure the engine is turned off, the vehicle is in Park and the Parking Brake is set.

### THREAD LOCKER USE

We have provided a small tube of thread locker in your kit. Whenever you see the symbol above on a step of the instructions apply 1 small drop of the thread locker to the threads of the screws or bolts. This will keep your hardware from vibrating loose during rough driving. If the hardware ever needs to be removed, do so slowly to avoid having the inserts strip out from the plastic.

### WARNING:

**THIS EQUIPMENT SHOULD BE INSTALLED, ADJUSTED, AND SERVICED BY PERSONNEL FAMILIAR WITH THE CONSTRUCTION AND OPERATION OF THIS TYPE OF EQUIPMENT AND THE HAZARDS INVOLVED. FAILURE TO OBSERVE THIS PRECAUTION COULD RESULT IN SEVERE INJURY. READ THIS MANUAL THOROUGHLY AND MAKE SURE YOU UNDERSTAND THE PROCEDURES BEFORE YOU ATTEMPT TO OPERATE THIS EQUIPMENT. THE PURPOSE OF THIS MANUAL IS TO PROVIDE YOU WITH INFORMATION NECESSARY TO SAFELY OPERATE, MAINTAIN, AND TROUBLESHOOT THIS EQUIPMENT. DO NOT USE THIS EQUIPMENT FOR ANY REASON OTHER THAN ITS INTENDED PURPOSE. FAILURE TO FOLLOW THESE INSTRUCTIONS WILL VOID ANY WARRANTY. KEEP THIS MANUAL FOR FUTURE REFERENCE. THE INFORMATION CONTAINED IN THIS MANUAL IS SUBJECT TO CHANGE WITHOUT NOTICE.**

Product will intake and expel both air and loose materials with high force and velocity.

- Install product on roll cage, so air inlet is not blocked.
- Do not place face, hair, extremities, clothing, or other loose material in front of air inlet or outlet during use.
- Install product securely to roll cage and avoid placing hair, extremities, clothing, or other loose material in front of air inlet during use.

Moving parts are sharp and could cause personal injury.

- Keep fan safety guard and exhaust cover in place while operating and after service.
- Disconnect product from power source before servicing.

Scavenge Fan is designed for use in conjunction with an UTV's operating manual, and state and federal law.

- Keep your seat belt fastened and wear a helmet while operating the vehicle.

Risk of electric shock!

- Improper installation, maintenance or operation could cause serious injury or property damage.

**SEE EXPLODED VIEW ON PAGE 7**

## INSTALLATION INSTRUCTIONS (CONTINUED)

1. Look under the driver's seat. Pull the seat adjuster and move the seat forward as far as possible.



2. Remove the center console cover by lifting up and sliding the tab out from its slot.



3. After removing the center console, make sure the grommets didn't come off with the cover or fall out of place.



4. Squeeze down and pull out on the stock air duct to remove it from the stock intake box.



5. Remove the foam seal from the stock air duct. Pull slowly on the inside around the duct to separate the factory adhesive from the duct. Be careful not to tear the foam.



6. Remove the cargo bed cover by removing the five quick turn fasteners.



7. Remove the air cleaner case cap by rotating counter clockwise.



8. Remove the stock foam air cleaner element.



9. Insert the Coupler (L) into the stock air box opening. Hook the flange groove onto the air box opening. You will need to squeeze and push to get the Coupler to sit right on the air box opening.



SEE EXPLODED VIEW ON PAGE 7

## INSTALLATION INSTRUCTIONS (CONTINUED)

10. Installing the Coupler (L) will be easier with an extra pair of hands. Someone from the front can push while the person by the stock intake box can guide the flange groove into the air box opening. Once the coupler is in position straighten out of the flanges so that the flange groove fits nicely and seals around the entire opening of the air box.



11. Reinstall the stock foam air cleaner element.



12. Reinstall the air cleaner case cap by rotating clockwise.



13. Reinstall the cargo bed cover and five quick turn fasteners.



14. Insert the foam seal removed in Step 5 into the gap around the Coupler (L).



15. Insert the Air Tube (M) and Hose Clamp #56 (O) into the Coupler (L). The edge of the part number should be facing straight ahead towards the front of the vehicle.



16. Install the Screw (S) and Prong (T) onto the Center Console (R) with a screwdriver and wrench. The screw should be tightened from the top into the prong. Use the supplied Threadlocker (W) on these threads.

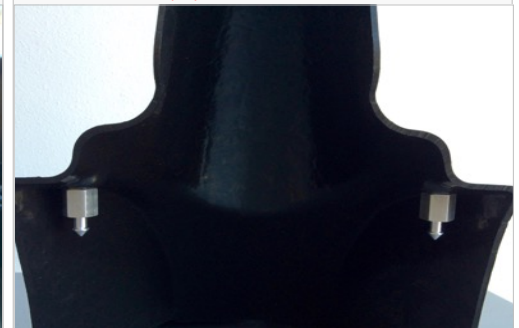

17. Install the Center Console (R) to check clearance for the Air Tube (M). Insert the center console tab into the shifter cover first and then push down on the center console to get the prongs into the grommets. Make sure that the Air Tube is not hitting the sides and there is enough clearance for the Duct (N). Once everything checks out, remove and set aside the Center Console. Check again to make sure that the grommets are still in place.



SEE EXPLODED VIEW ON PAGE 7

## INSTALLATION INSTRUCTIONS (CONTINUED)

18. Install the Strap (H) onto the roll cage. Loosely wrapping some plastic around the roll cage will help sliding the strap onto the roll cage easier and prevent scratches.



19. Install the Pivot Body (G) onto the Strap (H) with the supplied Screw (J), Washer (I), Locknut (K) on the roll cage. Do this for both sides. Do not fully tighten the screws and locknuts.



20. Use a 13mm wrench and 5mm Hex Key to install the Adapter (B) onto the bottom of the Particle Separator (A) with the supplied Screws (D), Washer (C) and Locknuts (E). Tighten these screws and locknuts.



21. When installing the L Bracket (F), make sure the ribs in the L Bracket are properly seated inside the grooves of the Adapter (B). Any misalignment will damage these parts. Do not attempt to rotate these parts once assembled. They are designed to lock into place once seated. Determine the proper angle to mount the L Bracket to the Adapter based on the desired location for the Particle Separator (A). Make sure the L Bracket is properly seated on the adapter before tightening it in place with the Screw (D) and Washer (C) using a 5mm Hex Key. Do not tighten the hardware if these parts are not seated properly or damage may result. Repeat for the other side of the Particle Separator and make sure the L Bracket on both sides are pointed in the same direction and are aligned with each other.



22. Install the L Bracket (F) onto the Pivot Body (G) using Screw (D) and Washer (C). Use a 5mm Hex Key to tightening the screw. You may have to adjust the position of the Strap (H) and pivot body to get the holes to lined up. Do this for both sides. Having an extra pair of hands holding the Particle Separator (A) will make the install easier.



23. Once you are satisfied with the position, use a 4mm Hex Key and 10mm wrench to tighten the Screw (J), Washer (I), Locknut (K) at the Strap (H). Do this for both sides. Go over all the screws and locknuts again to make sure they are secure and that the Particle Separator (F) is firmly attached to the roll cage.



24. Install Hose Clamp #56 (O) onto the Duct (N). (Optional) For a cleaner appearance, take the end of the wire and tuck it inside the duct. Do this for both ends of the duct if desired.



25. Insert one end of the Duct (N) and Hose Clamp (O) onto the Air Tube (M). Tighten the hose clamp at the air tube. Bring the other end towards the opening on the Particle Separator (A). Note the length on the duct you want to cut. We recommend cutting the duct an extra 3" longer so that the ends, along with any wire and strings, can be folded in for a cleaner look.



26. Pierce the Duct (N) centered between the two wire reinforcements using a razor blade to cut the duct to length. Cut all the way around. Try to cut the duct straight around the center as close as possible.



SEE EXPLODED VIEW ON PAGE 7

## INSTALLATION INSTRUCTIONS (CONTINUED)

27. Use scissors to begin the cut. Aim the scissors towards the start of the cut. Do not try to cut through the wire with scissors. Use a mini-bolt or a heavy duty wire cutter to finish the cutting through the wire and strings.



28. (Optional) Regular staples can be used to secure the ends of the strings to the duct.



29. Install the Duct (N) with Hose Clamp #56 (O) onto the plenum of the Particle Separator (A). Tighten the hose clamp with a flat head screwdriver or a 5/16 socket/nut driver



30. Familiarize yourself with the Wire Harness (U) and each of the connectors. Coming from the relay you have Connector A which has the fuse holder with the ring terminals for the battery. Wire B is used with the Posi-Tap (V) to tap into the power source. Connector C has the connector to power the Particle Separator (A).

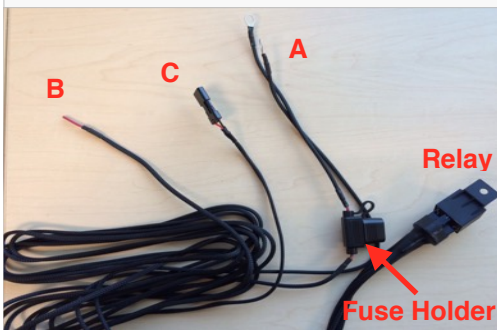

31. Install the ring terminals onto the battery terminal clamps. Red wire with the fuse holder to (+) and Black wire to (-). Secure the positive terminal first and then secure the negative terminal.



32. Find the fuse box and look for the brown wire with two green stripes located closest to the passenger side. The wire is connected to the HEAD (15A Fuse).

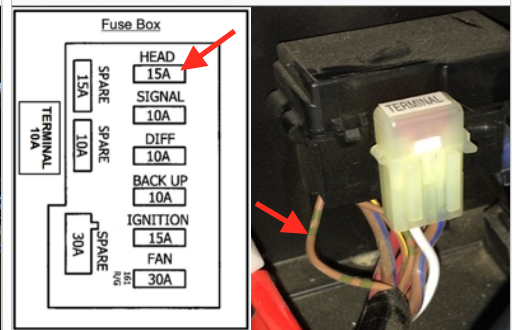

33. Unscrew the large top cap from the supplied Posi-Tap (V). Place the cap in between the wire.

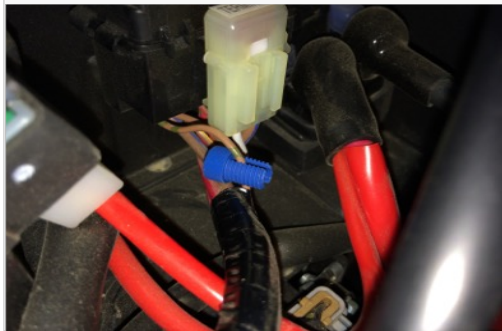

34. Screw the body around the cap until it is firmly tight.



35. Find Wire B and strip about 3/8" off the end of the wire using a wire stripper.



36. Unscrew the bottom cap on the Posi-Tap (V) and insert the Wire B through it.

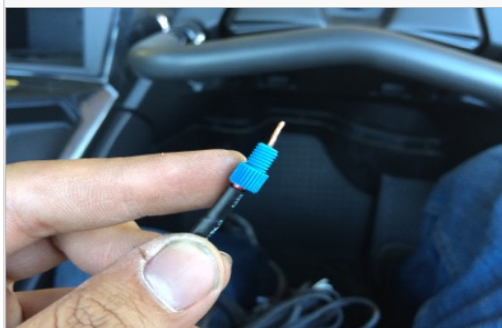

37. Insert the bottom cap and wire back into the Posi-Tap (V) making sure the strands go around the metal core. While holding the wire in place, screw the bottom cap back on until it is firmly tight. Double check both caps to make sure they are tight.

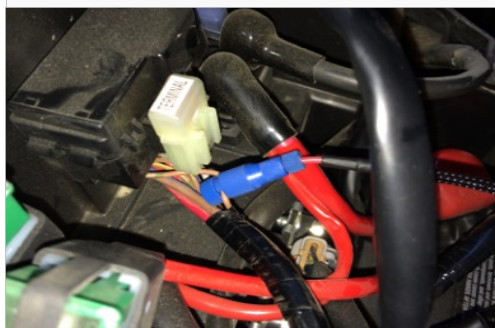

38. Find Connector C and connect it into the fan connector on the Particle Separator (A). Make sure not to cross the connectors. Power to power and ground (black) to ground (black). Note the color of the wires whenever connecting or disconnecting this connector. The connector should snap into each other with very little resistance. Do not try to force the connectors into each other.

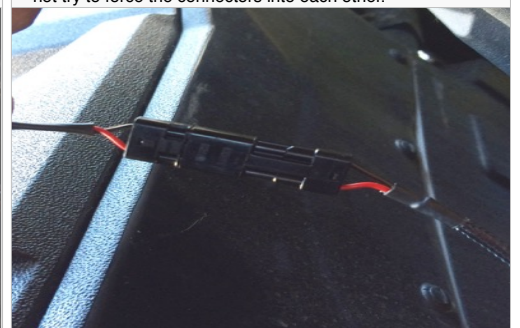

SEE EXPLODED VIEW ON PAGE 7

## INSTALLATION INSTRUCTIONS (CONTINUED)

39. Using the supplied Cable Ties (P) or Velcro (Q) to secure the Wire Harness (U) to the Duct (N).



40. Cable Tie (P) any excess Wire Harness (U) and secure it somewhere under the center console.



41. Install the Center Console (R).



42. Make sure the connectors are all plugged in and secure. Turn the ignition on and make sure air is blowing out the exhaust. If air is not blowing out, double check your electrical connections. Your installation is now complete.



### RELATED ITEMS FOR YOUR PURCHASE

- Stock Replacement Filter (Coming Soon)

Order online today at [www.sbfilters.com](http://www.sbfilters.com) or through your local S&B distributor.

### ONGOING MAINTENANCE

Your Particle Separator requires very little if any maintenance depending on where you drive; however, you should check to make sure that none of the openings on front of the Particle Separators are blocked by mud or other debris each time you exit the UTV. You should also make sure the scavenge fan is operating properly. To do so, simply check to make sure the fan is still blowing out air (for about 15-20 seconds) when you turn off your UTV as this is a normal condition. If the fan is not blowing out air or the airflow seems lower than when you initially installed your system, please contact S&B tech support. To clean your Particle Separator, review the cleaning instructions below.

SEE EXPLODED VIEW ON PAGE 7



**EXPLODED VIEW**

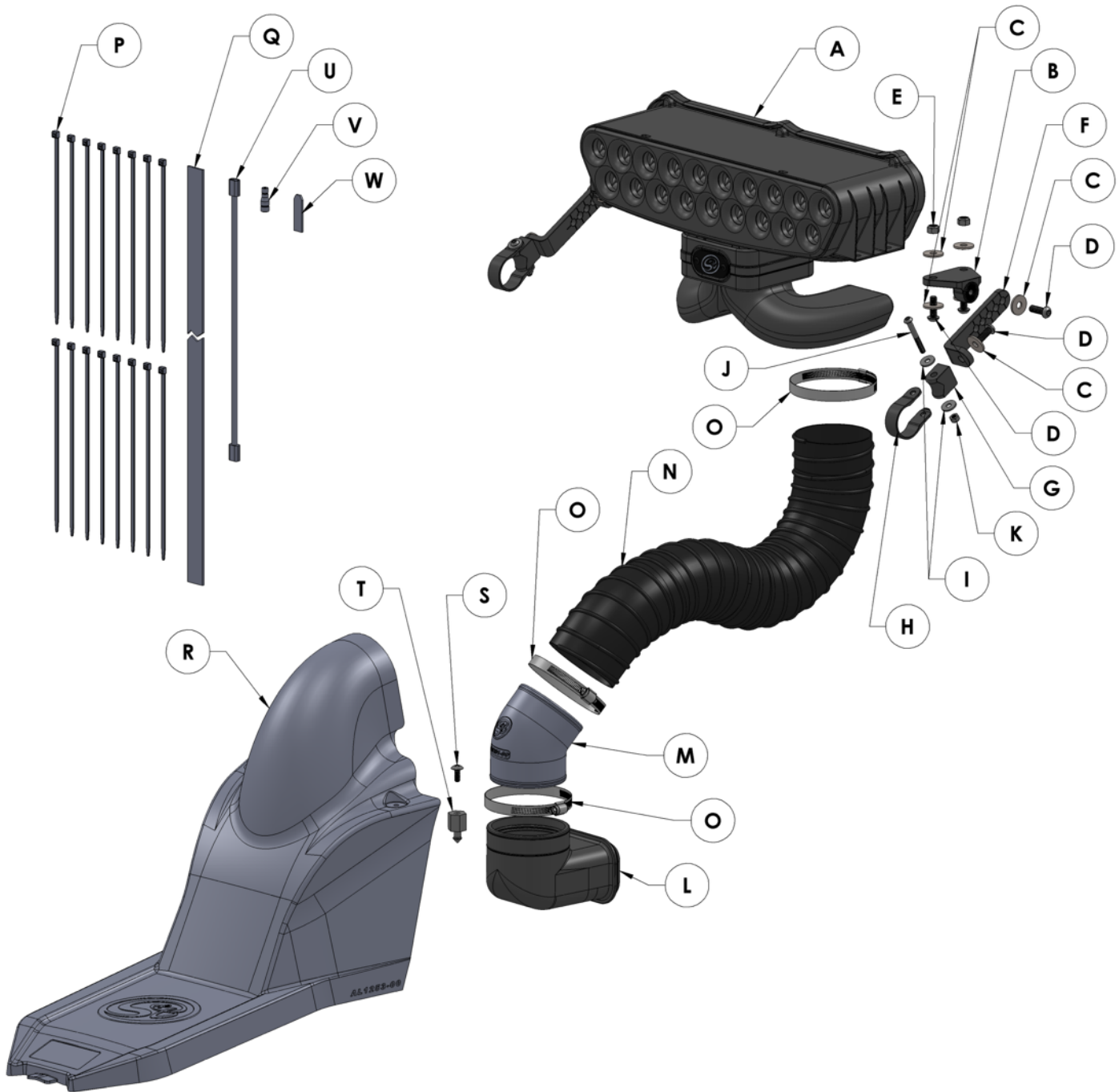

ITEM	QTY.	DESCRIPTION	PART NUMBER	ITEM	QTY.	DESCRIPTION	PART NUMBER
A	1	PARTICLE SEPARATOR	AL2002-00	M	1	AIR TUBE	AL1251-00
B	2	ADAPTER, CLAMPS	AI1780-00	N	1	DUCT	AI1735-01
C	12	WASHER, M8 SS	AI1742-00	O	3	HOSE CLAMP, #56	AG1019-00
D	8	SCREW, BHCS, M8 x 1.25 x 25 SS	AI1788-00	P	16	CABLE TIE	AI1750-00
E	4	LOCKNUT, M8 x 1.25	AI1736-00	Q	1	VELCRO	AI1779-01
F	2	L BRACKET, CLAMPS	AI1781-00	R	1	CENTER CONSOLE	AL1253-00
G	2	PIVOT BODY, CLAMPS	AI1782-00	S	2	SCREW, 1/4-20 x 50"lmg 18-4	AI1569-00
H	2	STRAP, CLAMPS	AI1795-00	T	2	PRONG	AI1791-00
I	4	WASHER, M6 SS	AI1755-00	U	1	WIRE HARNESS	AI1796-00
J	2	SCREW, M6 x 1 x 50mm	AI1801-00	V	1	POSI-TAP	AI1799-00
K	2	LOCKNUT, M6 x 1	AI1790-00	W	1	THREADLOCKER, BLUE	AI1595-00
L	1	COUPLER	AI1774C-00				